

E and D

AXIAL WALL FANS

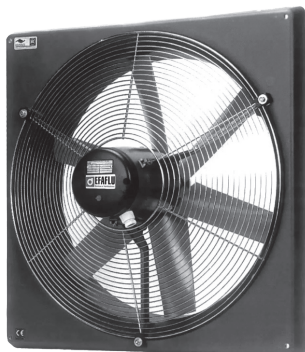

NOMENCLATURE

4 E 30 Q

- panel material - fiberglass reinforced polyester
- \varnothing of impeller
- **E** - single phase, **D** - three phase
- poles

APPLICATION

Axial fans used in agriculture and in other industry applications .

CONSTRUCTION

- Wall axial fan series E with single-phase motor, series D with three-phase motor.
- E and D: Panel in polyester reinforced with fiberglass and polypropylene. Temperatures up to 40 °C.
- Motors with housing in injected aluminum , 1400 RPM, 50Hz, IP55 and class F .
- Single-phase: 230V; Three-phase, 230/400V.
- Range up to diameter Ø920.

DESCRIPTION

Wall axial fans for use in agriculture and other industrial applications. Constituted by panel in aluminum series WS and panel in polyester reinforced with fiber glass in series E and D. The impellers are constructed in polypropylene.

These wall fans can be mounted horizontally or vertically. The flow rate can be controlled by frequency or voltage converter.

The three-phase electric motors are 400V, 50Hz, Class F and single-phase motors 230V, 50Hz and IP55 class F.

DIMENSIONS

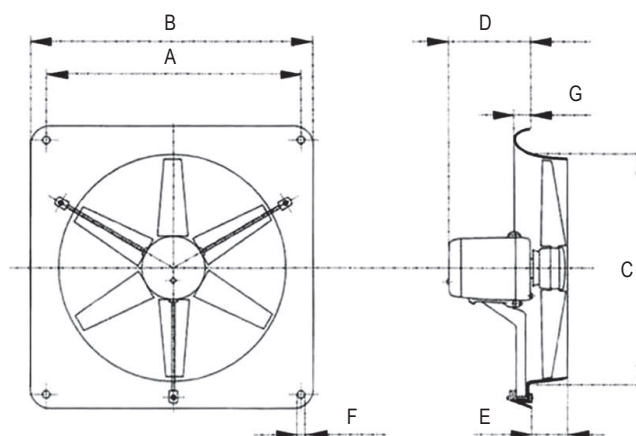

	mm							Dimensions of packing in mm (lxbxh)
	A	B	C	D máx.	E	F	G	
4E/D30Q	395	442.5	340	(192)	84	7.5	36	455x455x311
4E/D35Q	445	492.5	390	(192)	84	7.5	36	505x505x311
4E/D40Q	495	542.5	440	(192)	84	7.5	36	555x555x311
4E/D45Q	545	592.5	490	(192)	84	7.5	36	605x605x311
4E/D50Q	600	647.5	540	(192)	84	7.5	36	655x655x311

AXIAL WALL FANS

E and D

PERFORMANCE CURVES

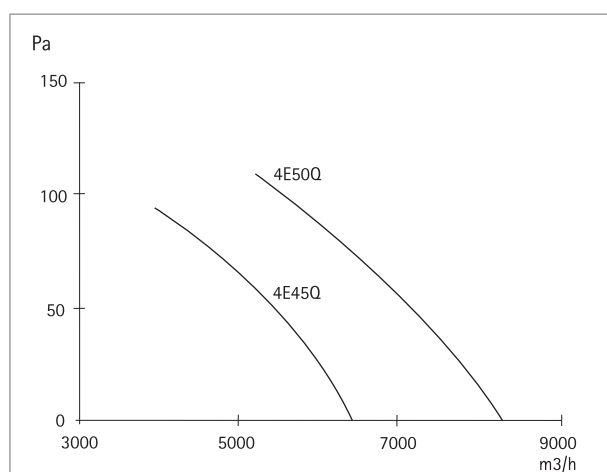
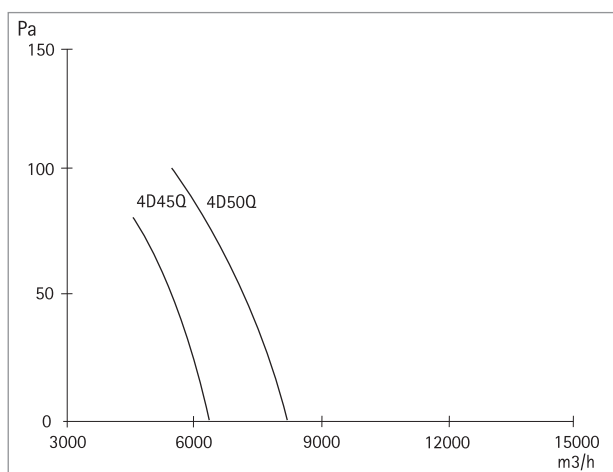
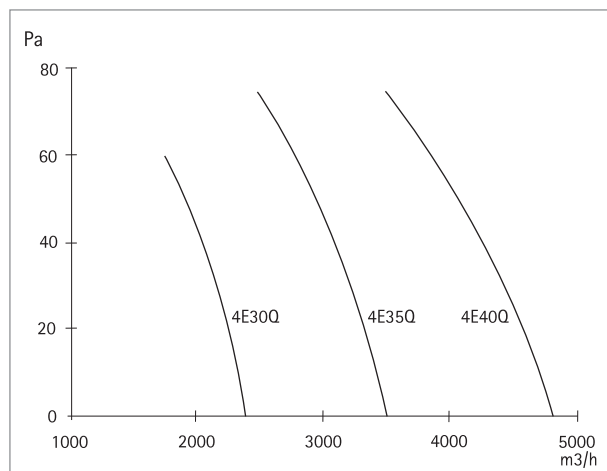
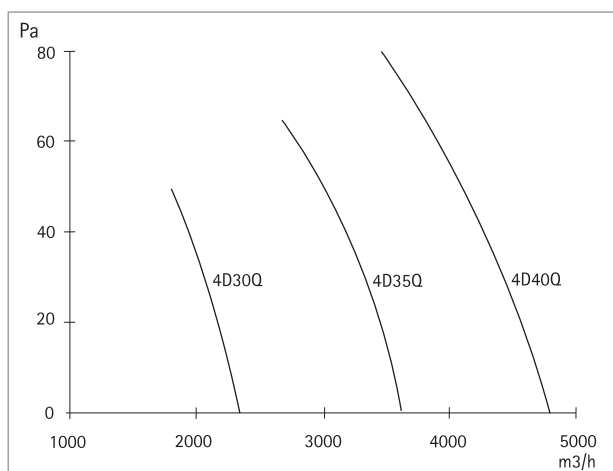

APPLICATION TYPES

Animals	Animal's weight kg	Necessary flow per animal m³/h
Dairy cows	500	190-240
Calves	60	30-50
Veal calves	150	60-100
Piglets	10	12-17
Pregnant sows	150	85-100
Growing pigs	100	60-70
Chickens	Aprox. 1	3-4,5
Laying hens	Aprox. 2	5,5-6,5
Turkeys	2.2	6-6,5
Rabbits for fattning	1,5 a 2	4-10
Female rabbits with litter	6 a 7	15-35
Male rabbits	4 a 5	10-30

The table by side allows you to determine for each Installation the air flow rate which is necessary to handle. Due to the special characteristics of each agricultural installation, it is recommended to use specialized installers for the determination of the flow rate defined.

E and D
AXIAL WALL FANS
TECHNICAL DATA

SINGLE PHASE ELECTRIC DATA										
230V 50Hz n		Impeller Ø in cm	Power (W)	W/1000 m³/h	dB (A)	Single phase electric data Amp.	Controller T/F	Ampere A (230V)	Cap. µF/400	kg (package)
TYPE										
1400 rpm	4E30Q	30	104	43.3	44	0.6	T/F	0.5	3	9.4
	4E35Q	35	170	48.2	47	1.1	T/F	0.9	4	10.4
	4E40Q	40	237	48.9	50	1.3	T/F	1.1	6	11.3
	4E45Q	45	317	49.5	52	1.9	T/F	1.6	8	13.1
	4E50Q	50	443	53.3	55	2.6	T/F	2.2	12	15.5

* controlled by transformer (T) or converter frequency (F)

THREE PHASE ELECTRIC DATA										
230/400V 50Hz n		Impeller Ø in cm	Power (W)	W/1000 m³/h	dB (A)	Motor Protection Amp.	Controller T/F	Ampere A (230V)	Ampere A (400V)	kg (package)
TYPE										
1400 rpm	4D30Q	30	94	40.5	44	0,6/0,3	T/F	0.5	0.3	9.4
	4D35Q	35	169	46.8	47	1,0/0,6	T/F	0.9	0.5	10.4
	4D40Q	40	225	46.7	50	1,1/0,7	T/F	1	0.6	11.3
	4D45Q	45	299	46.8	52	1,3/0,8	T/F	1.2	0.7	13.1
	4D50Q	50	414	50.2	55	2,1/1,2	T/F	1.9	1.1	15.5

* controlled by transformer (T) or converter frequency (F)

PRESCRIPTION TEXTS

Wall axial fan with panel polyester reinforced by fiberglass, impeller in polypropylene. Single-phase electric motor 230V or three-phase 230/400V with housing in aluminum injected alloy. The motor is fixed to the panel by three supports also in aluminum injected alloy. The motors support speed variation by voltage and/or frequency converter.

Type E/D EFAFLU brand